



Info prodotto 2103

16.02.2021

it's my window

NUOVE CERNIERE MINIMALI A 3 ALI ACP 62499 E ACP 62500 DOOR 62-72

Sono disponibili le nuove cerniere minimali a 3 ali per i sistemi Door 62/72. Le nuove cerniere avranno portata di 120 kg per due cerniere e 140 kg per tre cerniere.

Rispetto alle precedenti hanno un grado di registrazione in più (profondità).

Insieme alle cerniere cambiano anche le rispettive dime.

Nelle pagine seguenti trovate:

- Elenco applicazione cerniere (pag. 2,3);
- Portata max cerniere (pag. 4);
- Lavorazioni cerniere per tipologia (pag. 5-10);
- Lavorazioni con nuove dime (pag. 11-14);
- Istruzioni di montaggio (pag. 15-20).



EasyDoor	
Ecoslim 50 TT	
Ecoslim 62 TT	
Ecoslim 72 TT	
Elite Door 72	
Door 62	●
Door 72	●
Sirio 50	
Smart 30	
Planet 45	
Planet 50 TT	
Planet 50 PLUS	
Planet 62 TT	
Planet 62 PLUS	
Planet 72 HT	
Planet 72 PLUS	
3G	
Fullglazing	
Matic 50	
Matic 50 PLUS	
Matic 62 TT	
Matic 62 PLUS	
Matic 72	
Matic 72 PLUS	
3G Matic	
Nathura 59	
Nathura 70	
Nathura 82	
Nathura 92	
Slide 60	
Slide 65	
Slide 80/106 PLUS	
Topslide 160 PLUS	
Slidewood 160	
Topslidewood 214	
Panoramico	
Balconi e balaustre	

Info prodotto 2103

16.02.2021

ELENCO APPLICAZIONE CERNIERE

DOOR 62

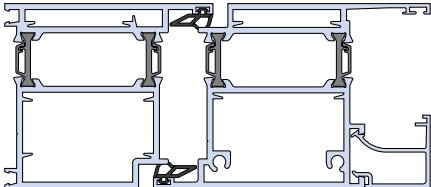
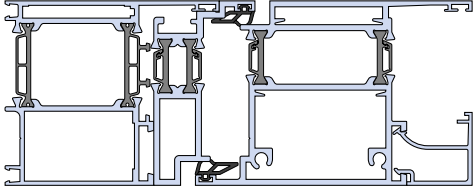
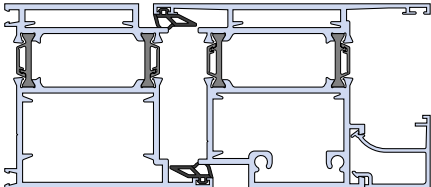
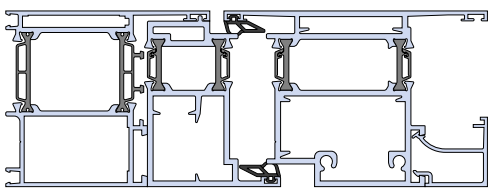
DOOR 62			
	NODO	CERNIERA MINIMALE	KIT CONTROPIASTRE
A	<p>Nodo laterale apertura interna</p>  <p>TT 61533 + TT 61535</p>	ACP 62499	ACP 62501
B	<p>Nodo laterale apertura interna</p>  <p>TT 61833 + TT 61584 + TT 61535</p>	ACP 62500	ACP 62502
C	<p>Nodo laterale apertura esterna</p>  <p>TT 61534 + TT 61537</p>	ACP 62499	ACP 62503
D	<p>Nodo laterale apertura esterna</p>  <p>TT 61833 + TT 61523 + TT 61537</p>	ACP 62499	ACP 62504

Info prodotto 2103

16.02.2021

ELENCO APPLICAZIONE CERNIERE DOOR 72

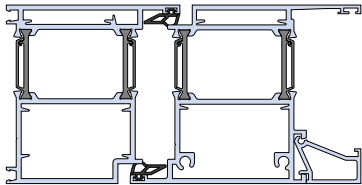
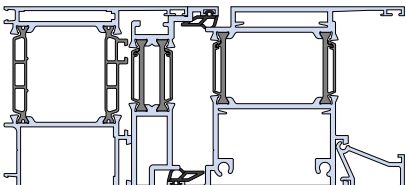
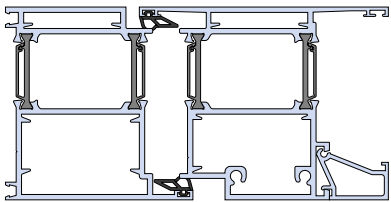
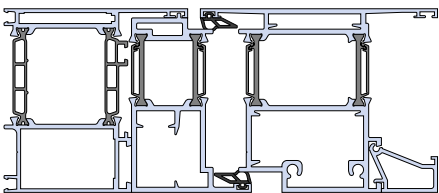
DOOR 72			
	NODO	CERNIERA MINIMALE	KIT CONTROPIASTRE
E	<p>Nodo laterale apertura interna</p>  <p>TT 71533 + TT 71535</p>	ACP 62499	ACP 62501 pag. 5
F	<p>Nodo laterale apertura interna</p>  <p>TT 71833 + TT 71584 + TT 71535</p>	ACP 62500	ACP 62502 pag. 10
G	<p>Nodo laterale apertura esterna</p>  <p>TT 71534 + TT 71537</p>	ACP 62499	ACP 62505 pag. 8
H	<p>Nodo laterale apertura esterna</p>  <p>TT 71833 + TT 71523 + TT 71537</p>	ACP 62499	ACP 62506 pag. 9

Info prodotto 2103

16.02.2021

PORTATA MAX CERNIERE

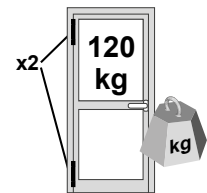

x2
120 kg

Pmax	L												
	600	700	800	900	1000	1100	1200	1300	1400	1500	1600	1700	1800
3000	120	120	120	120	120	120	120	120	120	107	97	90	
2900	120	120	120	120	120	120	120	120	113	101	93	86	
2800	120	120	120	120	120	120	120	120	106	96	89	83	
2700	120	120	120	120	120	120	120	112	100	91	85	80	
2600	120	120	120	120	120	120	120	105	95	87	82	77	
2500	120	120	120	120	120	120	111	99	90	83	78	74	
2400	120	120	120	120	120	104	93	86	80	76	72		
2300	120	120	120	120	120	111	98	88	82	77	73	70	
2200	120	120	120	120	120	103	92	84	78	74	70	68	
2100	120	120	120	120	110	96	87	80	75	71	68	65	
2000	120	120	120	120	102	90	82	76	72	69	66	64	
1900	120	120	120	109	94	85	78	73	69	66	64	62	
1800	120	120	120	100	88	80	74	70	67	64	62	X	
1700	120	120	108	92	83	76	71	67	64	62	X	X	
1600	120	120	98	86	78	72	68	65	62	X	X	X	
1500	120	107	90	80	73	69	65	62	X	X	X	X	
1400	120	96	83	75	69	65	62	X	X	X	X	X	
1300	105	87	77	71	66	63	X	X	X	X	X	X	
1200													

Elemento regolazione verticale x2

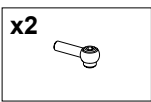

+ x2

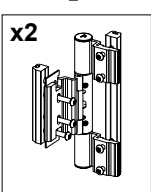

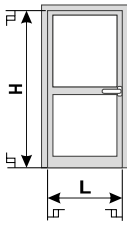

X Dimensioni non consentite
Dimensions not allowed

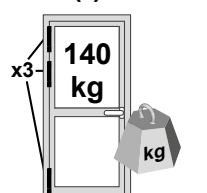

x3
140 kg

Pmax	L												
	600	700	800	900	1000	1100	1200	1300	1400	1500	1600	1700	1800
3000	140	140	140	140	140	140	140	140	140	124	113	105	
2900	140	140	140	140	140	140	140	140	131	118	108	101	
2800	140	140	140	140	140	140	140	140	124	112	103	97	
2700	140	140	140	140	140	140	140	131	117	107	99	93	
2600	140	140	140	140	140	140	140	123	111	102	95	90	
2500	140	140	140	140	140	140	130	115	105	97	92	87	
2400	140	140	140	140	140	140	121	109	100	93	88	84	
2300	140	140	140	140	140	129	114	103	95	90	85	81	
2200	140	140	140	140	140	120	107	98	91	86	82	79	
2100	140	140	140	140	128	112	101	93	88	83	79	76	
2000	140	140	140	140	118	105	96	89	84	80	77	74	
1900	140	140	140	127	110	99	91	85	81	77	74	72	
1800	140	140	140	117	103	93	87	82	78	75	72	X	
1700	140	140	126	108	96	88	83	78	75	72	X	X	
1600	140	140	115	100	91	84	79	75	72	X	X	X	
1500	140	124	105	93	86	80	76	73	X	X	X	X	
1400	140	112	97	88	81	76	73	X	X	X	X	X	
1300	123	102	90	82	77	73	X	X	X	X	X	X	
1200													

Elemento regolazione verticale x3

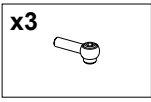

+ x3

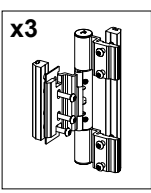

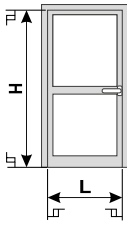

(*)



P = 0,83xPmax



**CON FRENO IN APERTURA
OPEN WITH BRAKE**
P = 0,57xPmax

X Dimensioni non consentite
Dimensions not allowed

Info prodotto 2103

16.02.2021

LAVORAZIONE CERNIERA - TIPOLOGIA A, E *

DOOR 62/72

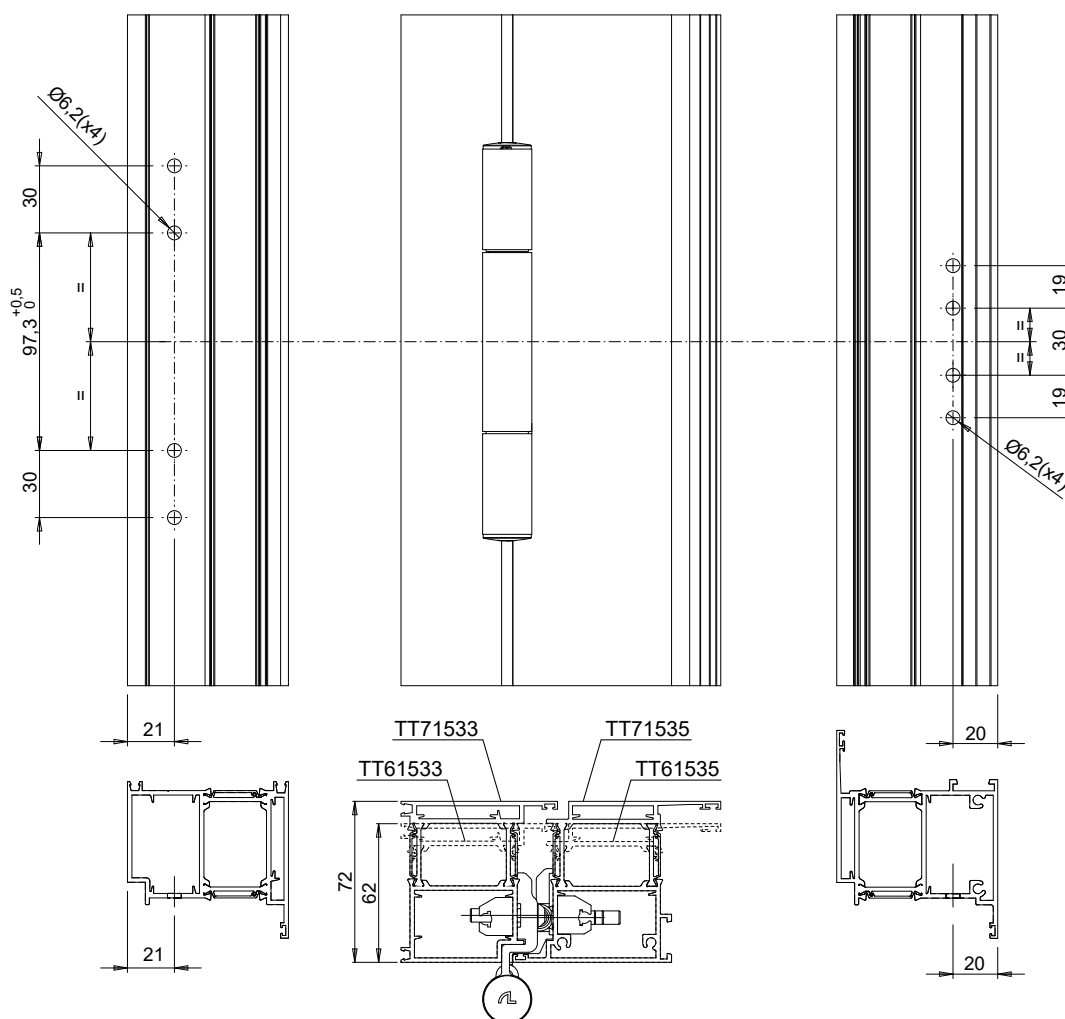

ACP 62499

+

ACP 62501

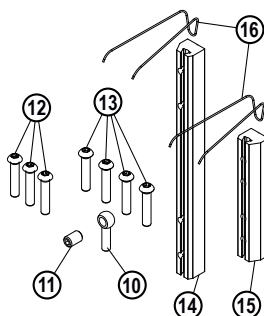
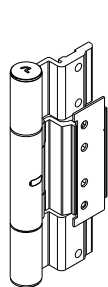

- 10- Elemento regolazione verticale/*Vertical adjustment element*
- 11- Grano/*Grubscrew M8x12 UNI5923 ESLOK*
- 12- Viti anta/*Sash screws M6X30 ISO7380-A2 (TORX 30)*
- 13- Viti telaio/*Frame screws M6X30 ISO7380-A2 (TORX 30)*
- 14- Contropiastra telaio/*Frame counterplate*
- 15- Contropiastra anta/*Sash counterplate*
- 16- Molle piastri/*Retaining springs*

* Vedi tabella pag. 2-3.

Info prodotto 2103

16.02.2021

LAVORAZIONE CERNIERA - TIPOLOGIA C *

DOOR 62

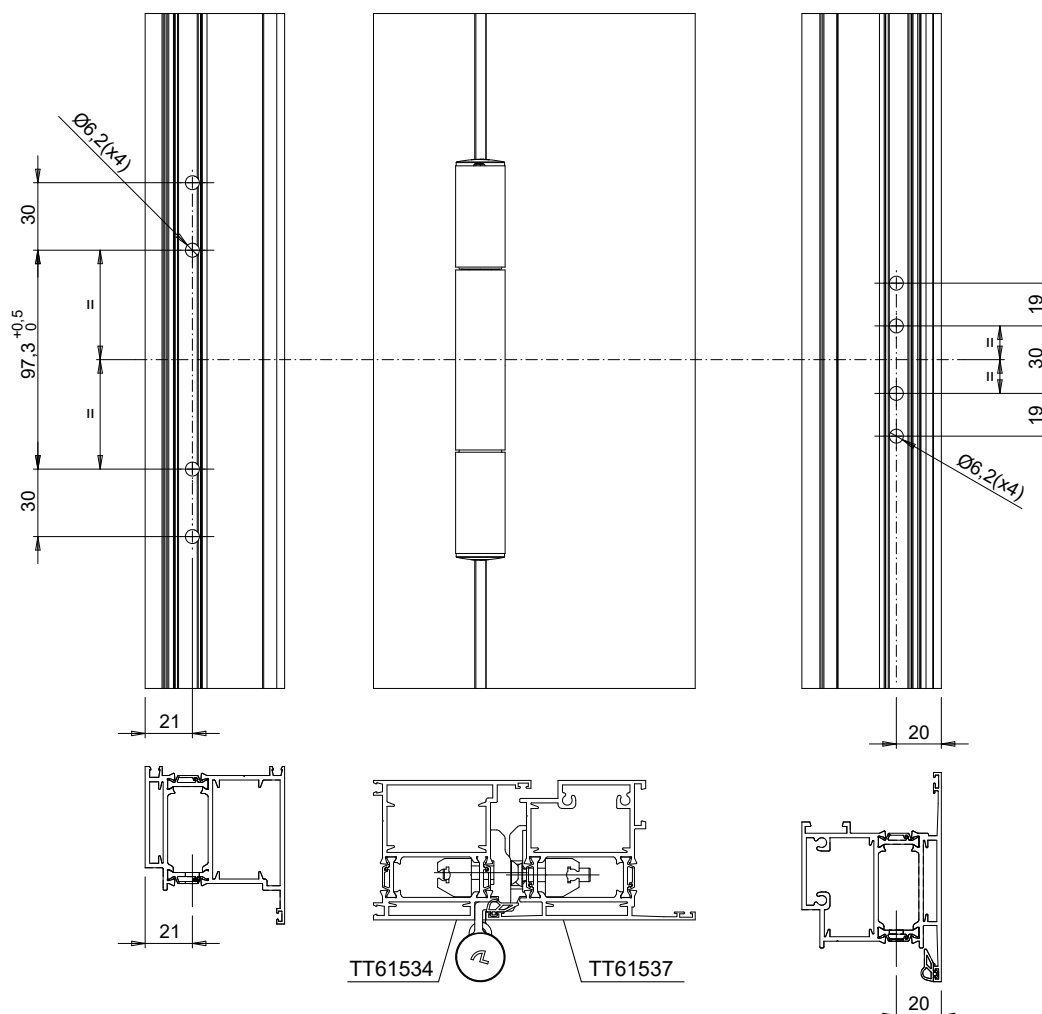

ACP 62499

+

ACP 62503

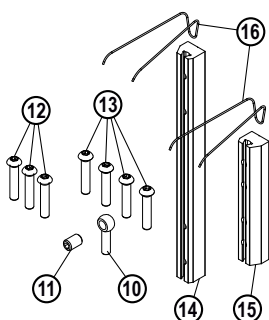
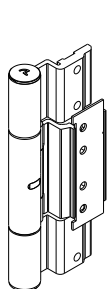

- 10- Elemento regolazione verticale/*Vertical adjustment element*
- 11- Grano/*Grubscrew M8x12 UNI5923 ESLOK*
- 12- Viti anta/*Sash screws M6X30 ISO7380-A2 (TORX 30)*
- 13- Viti telaio/*Frame screws M6X30 ISO7380-A2 (TORX 30)*
- 14- Contropiastra telaio/*Frame counterplate*
- 15- Contropiastra anta/*Sash counterplate*
- 16- Molle piastri/*Retaining springs*

* Vedi tabella pag. 2-3.

Info prodotto 2103

16.02.2021

LAVORAZIONE CERNIERA - TIPOLOGIA D *

DOOR 62

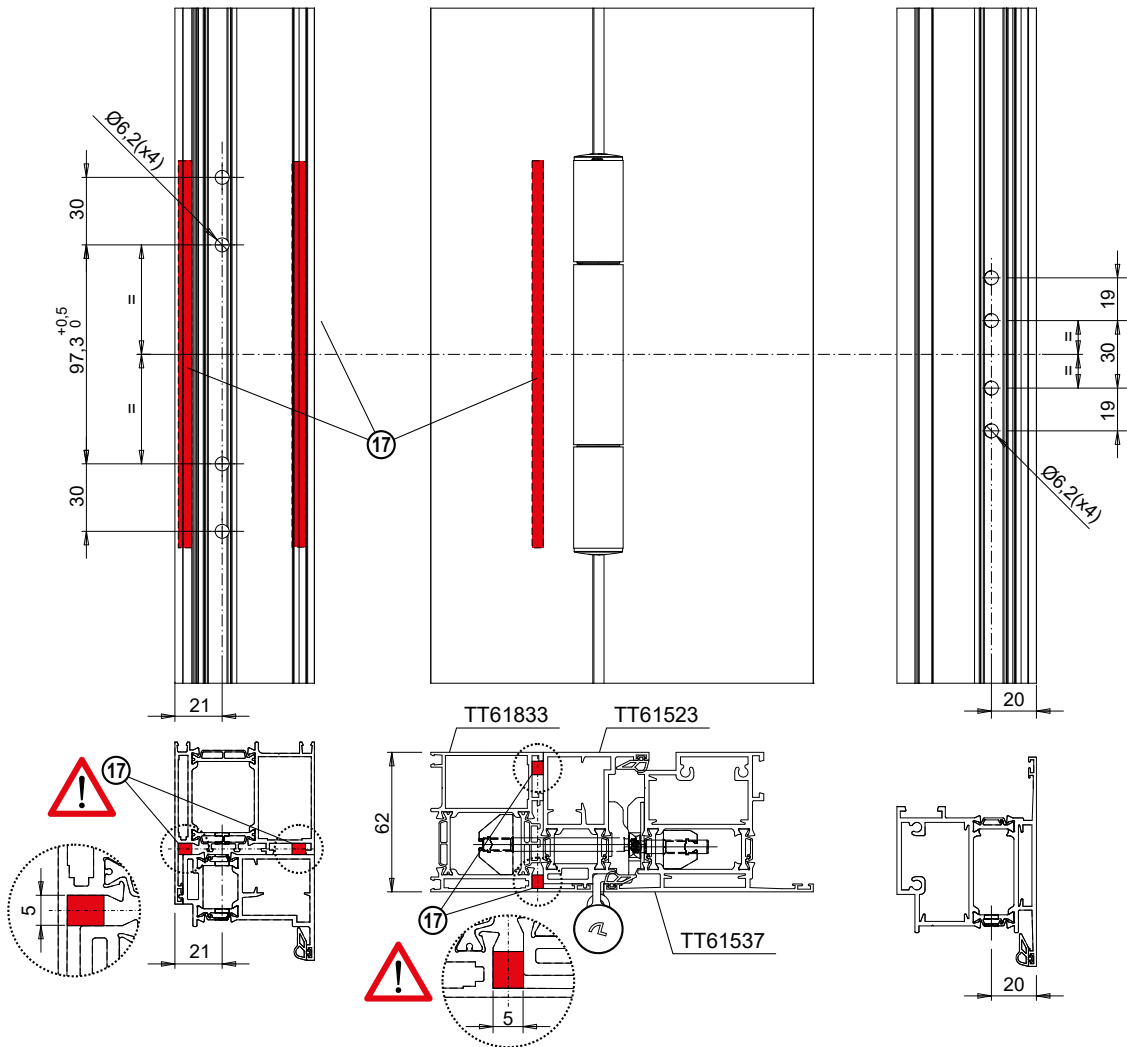

ACP 62499

+

ACP 62504

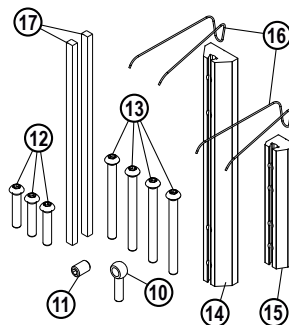
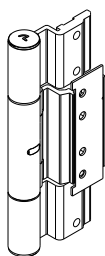

- 10- Elemento regolazione verticale/Vertical adjustment element
- 11- Grano/Grubscrew M8x12 UNI5923 ESLOK
- 12- Viti anta/Sash screws M6X30 ISO7380-A2 (TORX 30)
- 13- Viti telaio/Frame screws M6X65 ISO7380-A2 (TORX 30)
- 14- Contropiastra telaio/Frame counterplate
- 15- Contropiastra anta/Sash counterplate
- 16- Molle piastri/Retaining springs
- 17- Distanziali profili telaio/Frame profiles Spacers

* Vedi tabella pag. 2-3.

LAVORAZIONE CERNIERA - TIPOLOGIA G *

DOOR 72

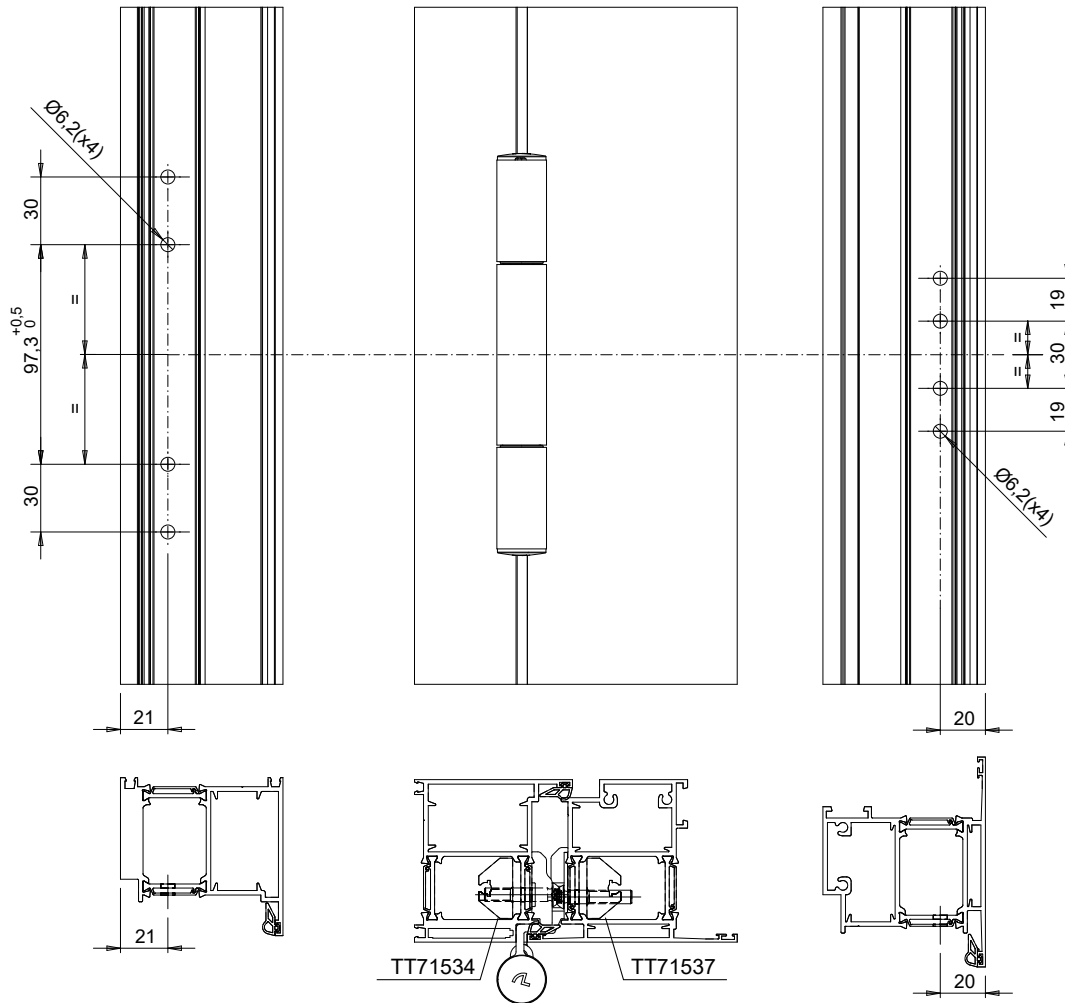

ACP 62499

+

ACP 62505

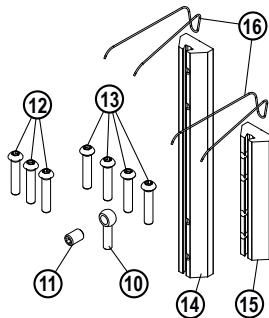
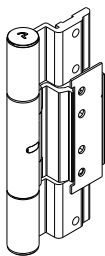

- 10- Elemento regolazione verticale/*Vertical adjustment element*
- 11- Grano/*Grubscrew* M8x12 UNI5923 ESLOK
- 12- Viti anta/*Sash screws* M6X30 ISO7380-A2 (TORX 30)
- 13- Viti telaio/*Frame screws* M6X65 ISO7380-A2 (TORX 30)
- 14- Contropiastra telaio/*Frame counterplate*
- 15- Contropiastra anta/*Sash counterplate*
- 16- Molle piastrino/*Retaining springs*

* Vedi tabella pag. 2-3.

Info prodotto 2103

16.02.2021

LAVORAZIONE CERNIERA - TIPOLOGIA H *

DOOR 72

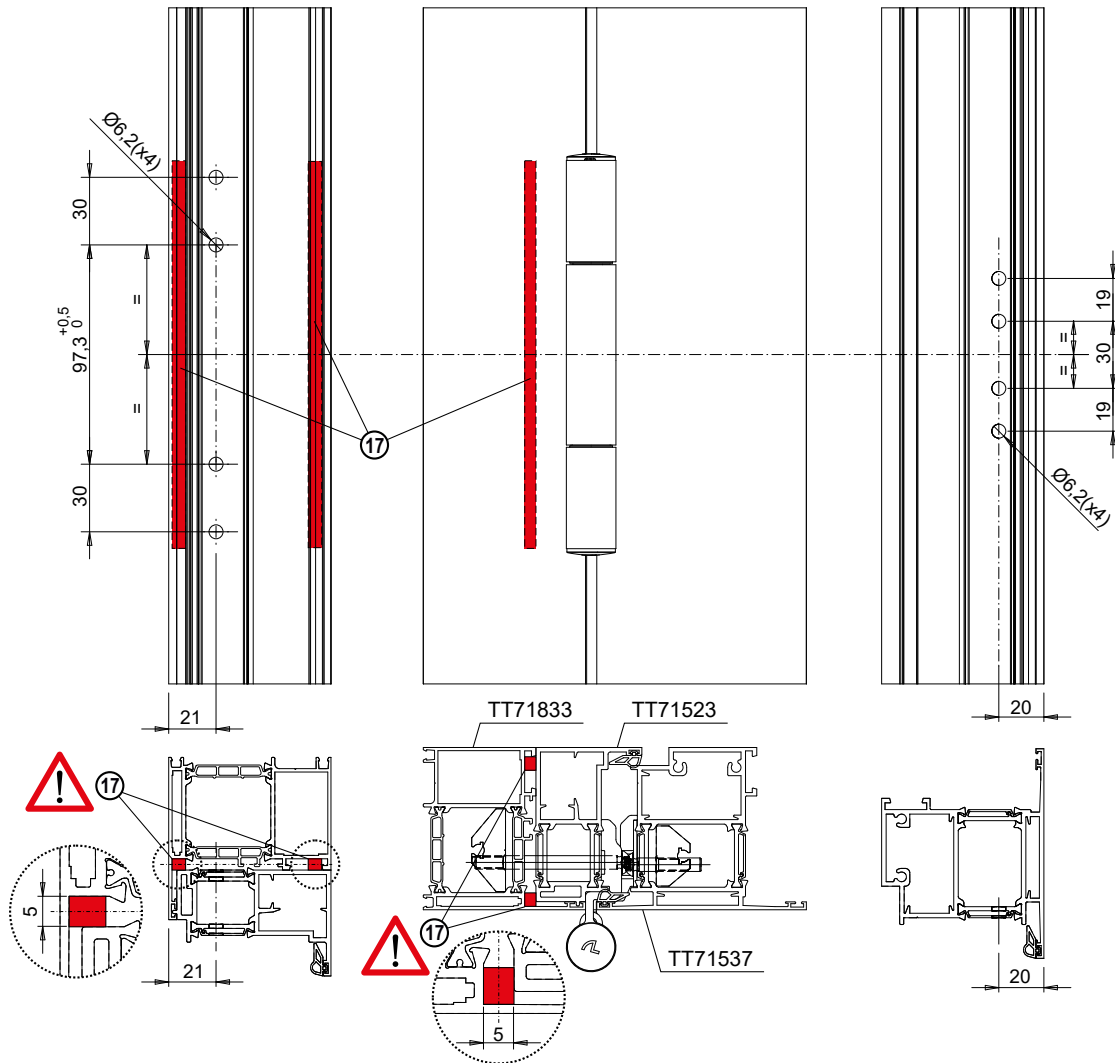

ACP 62499

+

ACP 62506

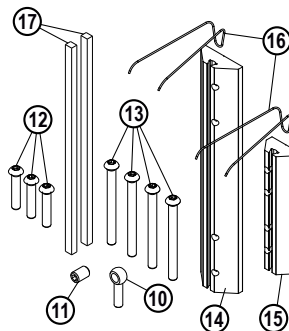
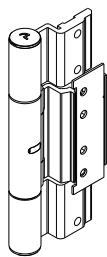

- 10- Elemento regolazione verticale/Vertical adjustment element
- 11- Grano/Grubscrew M8x12 UNI5923 ESLOK
- 12- Viti anta/Sash screws M6X30 ISO7380-A2 (TORX 30)
- 13- Viti telaio/Frame screws M6X65 ISO7380-A2 (TORX 30)
- 14- Contropiastra telaio/Frame counterplate
- 15- Contropiastra anta/Sash counterplate
- 16- Molle piastrino/Retaining springs
- 17- Distanziali profili telaio/Frame profiles Spacers

* Vedi tabella pag. 2-3.

Info prodotto 2103

16.02.2021

LAVORAZIONE CERNIERA - TIPOLOGIA B, F *

DOOR 62/72

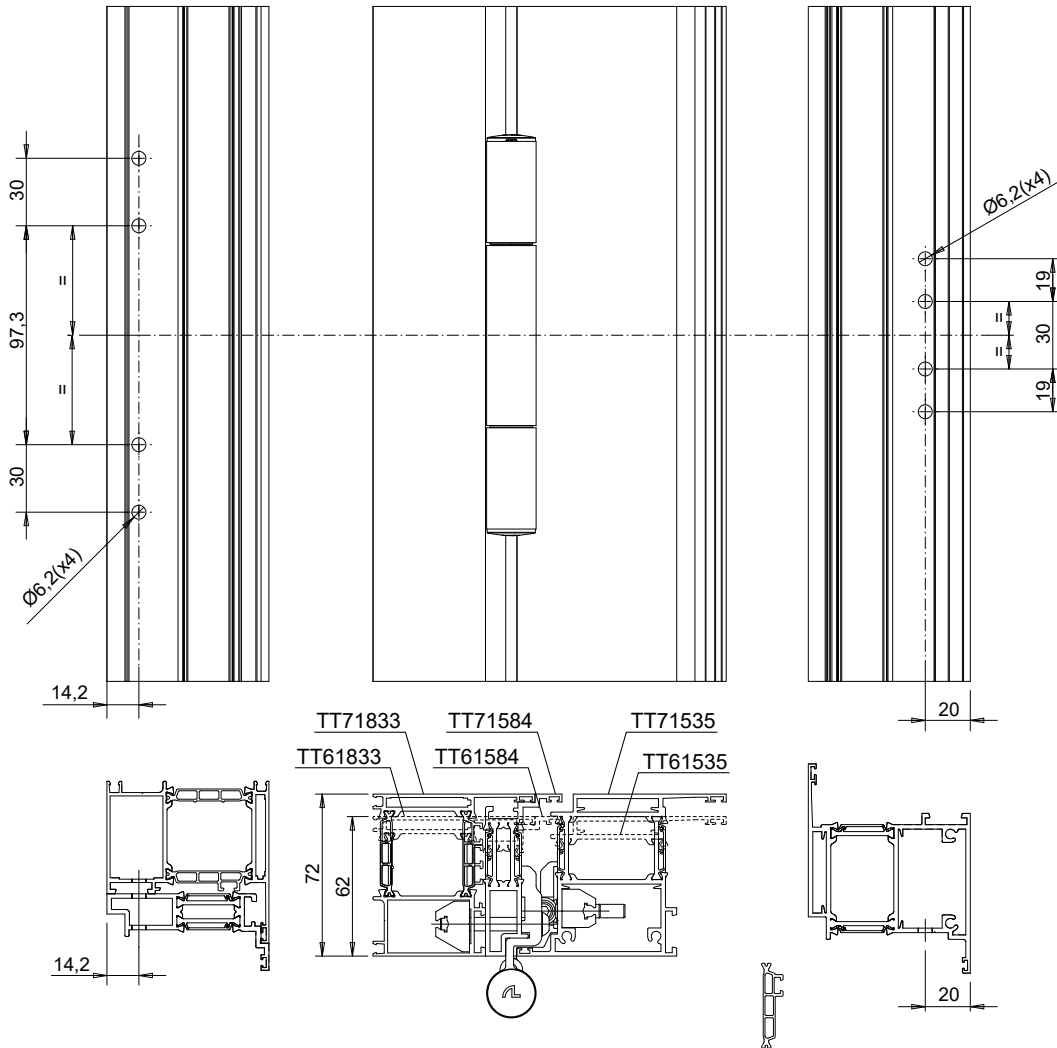

ACP 62500

+

ACP 62502

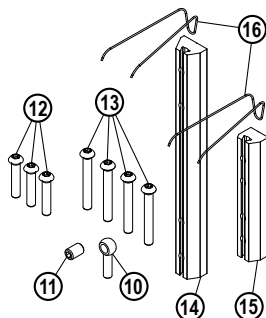
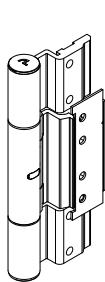

- 10- Elemento regolazione verticale/*Vertical adjustment element*
- 11- Grano/*Grubscrew* M8x12 UNI5923 ESLOK
- 12- Viti anta/*Sash screws* M6X30 ISO7380-A2 (TORX 30)
- 13- Viti telaio/*Frame screws* M6X30 ISO7380-A2 (TORX 30)
- 14- Contropiastra telaio/*Frame counterplate*
- 15- Contropiastra anta/*Sash counterplate*
- 16- Molle piastri/*Retaining springs*

* Vedi tabella pag. 2-3.

Info prodotto 2103

16.02.2021

LAVORAZIONI CON NUOVE DIME

CERNIERA MINIMALE ACP 62499/ACP 62500

LAVORAZIONE TELAIO CON DIMA ACP 62485M

Preparazione - Preparation

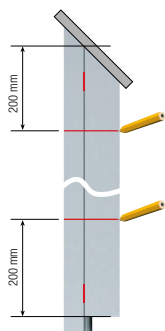

Segnare i profili non ancora montati
Posizionare i profili uno accanto all'altro e regolare la fuga tramite distanziali.
Distanze suggerite per il montaggio delle cerniere: sopra 200 mm e sotto 200 mm.
Segnare posizione centrale della cerniera.

*Mark profiles that are still unmounted
Place the profiles next to the other and adjust the gap by means of spacers.
Distances recommended for mounting hinges: above 200 mm and under 200 mm.
Score central hinge position.*

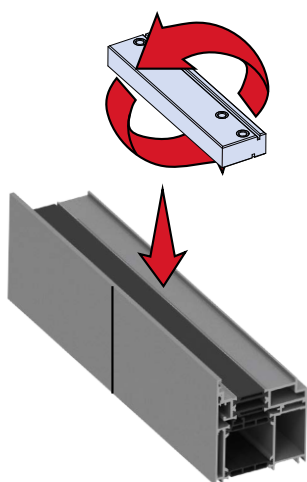

Posizionare la dima ACP 62485M al centro del segno precedentemente fatto a 200mm sull'anta tenendo in considerazione le due possibili posizioni in base alla tipologia di profilo da forare

Place ACP 62485M in the centre of the mark done before at 200mm on the sash watching out the two types of position in relation with the profile code

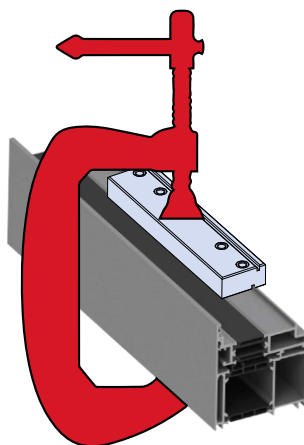

Una volta posizionata correttamente la dima, serrarla al profilo utilizzando dei morsetti

Once put the jig in place correctly, lock it to the profile using clamps

Info prodotto 2103

16.02.2021

LAVORAZIONE TELAIO CON DIMA ACP 62485M

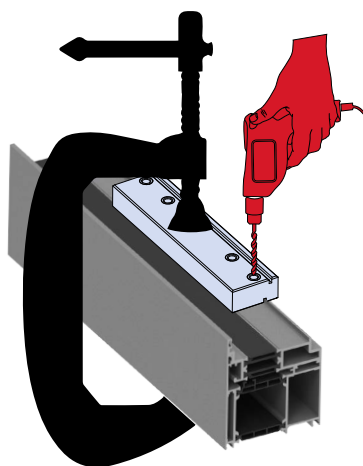

È possibile ora praticare i fori e rimuovere la dima una volta ultimata l'operazione

Is it possible now to make the holes and, once finished, to remove the jig

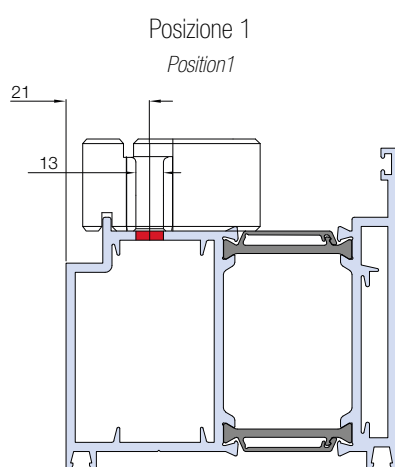

TT 61523

TT 71523

TT 61533

TT 71533

TT 61534

TT 71534

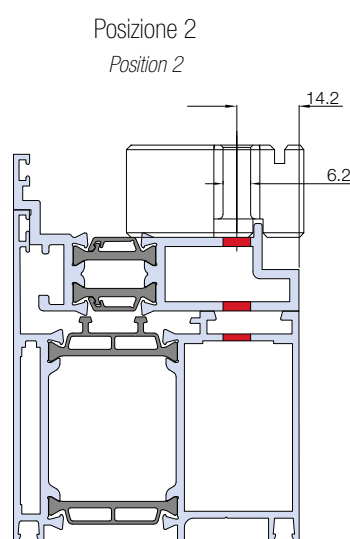
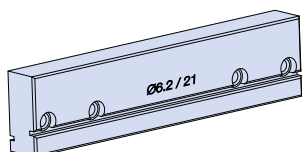

TT 61584

TT 71584

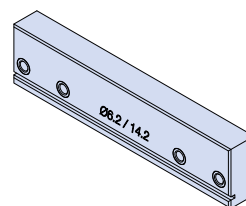

Fissare ulteriormente i profili di riporto TT 61523, TT 71523, TT 61584 e TT 71584 con due viti a 40mm dalle cerniere sia superiore che inferiore

Fix further the profiles TT 61523, TT 71523, TT 61584 e TT 71584 with two screws at 40mm from the upper and lower hinges



it's my window

Info prodotto 2103

16.02.2021

LAVORAZIONE ANTA CON DIMA ACP 62486M

Preparazione - Preparation

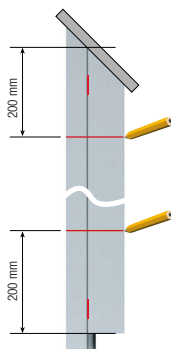

Segnare i profili non ancora montati
 Posizionare i profili uno accanto all'altro e regolare la fuga tramite distanziali.
 Distanze suggerite per il montaggio delle cerniere: sopra 200 mm e sotto 200 mm.
 Segnare posizione centrale della cerniera.

*Mark profiles that are still unmounted
 Place the profiles next to the other and adjust the gap by means of spacers.
 Distances recommended for mounting hinges: above 200 mm and under 200 mm.
 Score central hinge position.*

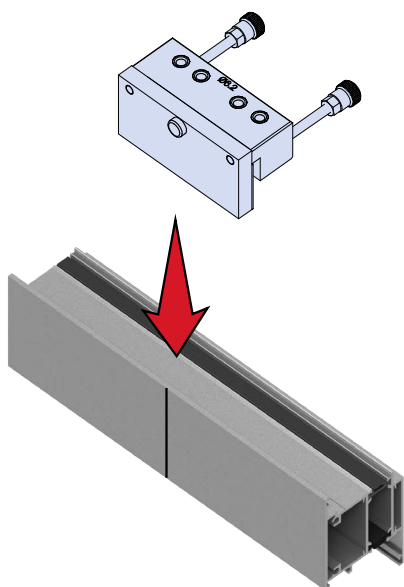

Posizionare la dima ACP 62486M al centro del segno precedentemente fatto a 200mm sull'anta tenendo in considerazione le due possibili posizioni in base alla tipologia di profilo da forare

Place ACP 62486M in the centre of the mark done before at 200mm on the sash watching out the two types of position in relation with the profile code

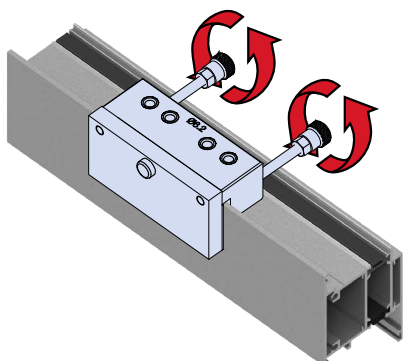

Una volta posizionata correttamente la dima, serrarla al profilo avvitando le manopole

Once put the jig in place correctly, lock it to the profile using handles



Info prodotto 2103

16.02.2021

LAVORAZIONE ANTA CON DIMA ACP 62486M

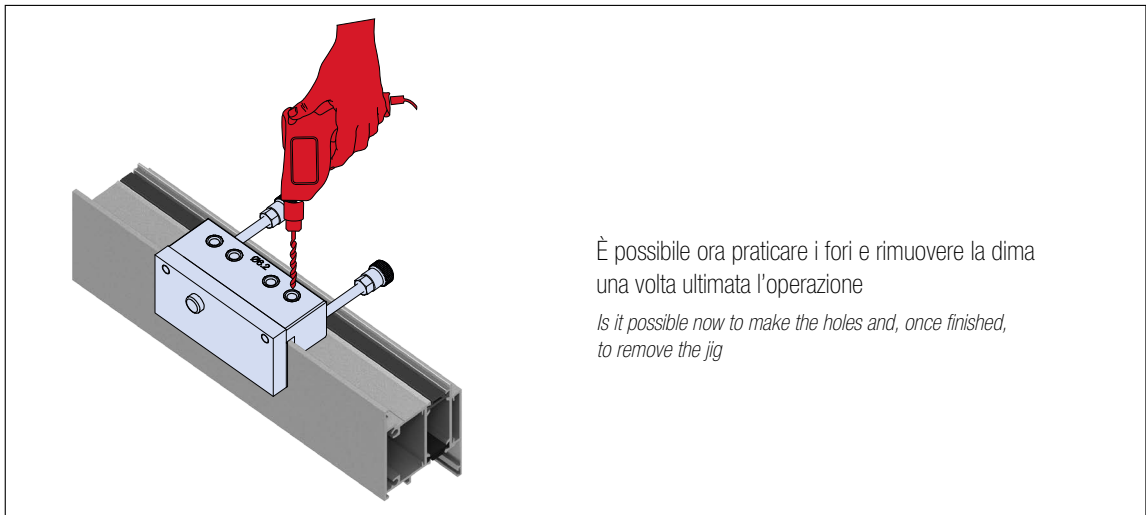

Posizione 1
Position 1

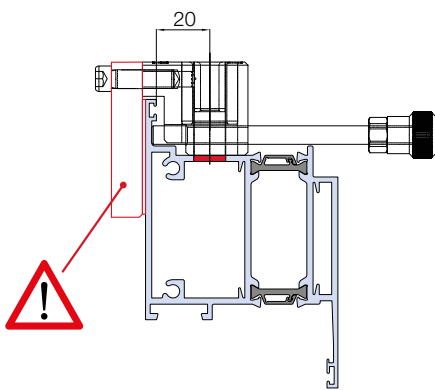

TT 61535

TT 71535

Posizione 2
Position 2

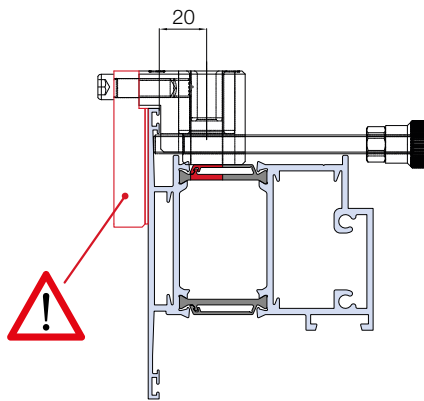

TT 61537

TT 71537

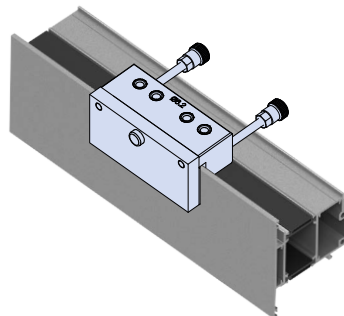
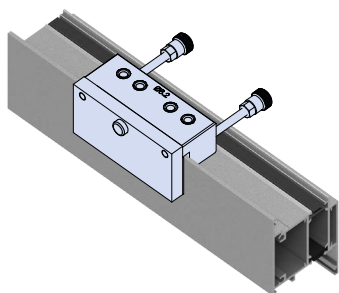

ISTRUZIONI DI MONTAGGIO

ISTRUZIONI DI MONTAGGIO

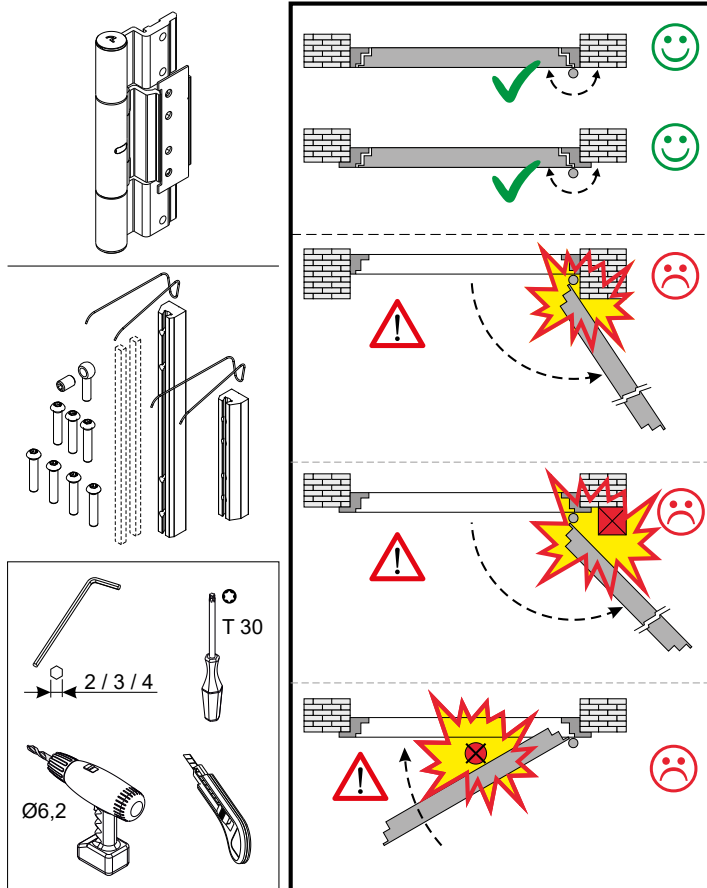

! L'efficacia e la sicurezza del prodotto dipendono dal rispetto di queste istruzioni; leggerle attentamente prima di utilizzare il prodotto. Il prodotto è progettato per una facile installazione, rimozione e manutenzione fornite in questa pubblicazione. Raccomandiamo che il prodotto sia installato da un tecnico qualificato. Utilizzare solo gli accessori consigliati in questa pubblicazione. Il prodotto soddisfa le attuali normative UE. I limiti di applicazione specificati dal produttore devono essere rispettati scrupolosamente. Il produttore non si assume alcuna responsabilità per inosservanza dei limiti applicativi, mancato utilizzo degli accessori consigliati o inosservanza delle istruzioni di installazione specificate in questa pubblicazione.

! *The effectiveness and safety of the product depend on these instructions being observed; read them carefully before using the product. The product is designed for easy installation. Follow the installation, removal and maintenance instructions given in this publication. We recommend that the product be installed by a qualified technician. Only use the accessories recommended in this publication. The product satisfies current EU regulations. The Manufacturer's specified limits of use must be observed scrupulously. The Manufacturer is not liable if the limits of use are ignored and the recommended accessories are not employed, and if the installation instructions given in this publication are not followed to the full.*

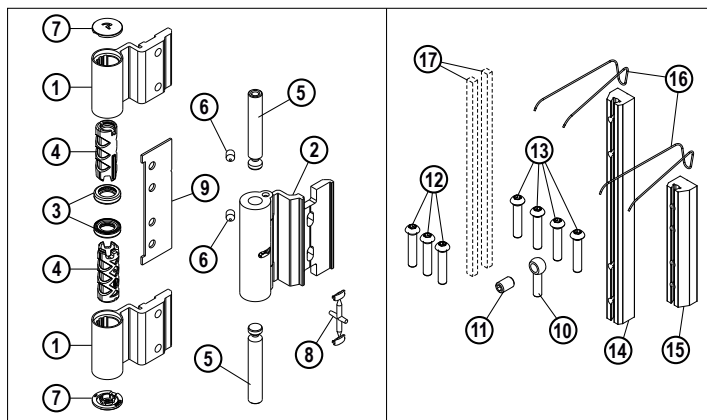

- | | |
|-------------------------------------|---|
| 1 Cerniera telaio/Frame hinges | 10 Elemento regolazione verticale/Vertical adjustment element |
| 2 Cerniera anta/Sash hinge | 11 Grano M6x12/M8x12 grub screw |
| 3 Cuscinetto/Ball bearings | 12 Viti anta M6/Sash M6 screws (Torx 30) |
| 4 Boccia/Bushings | 13 Viti telaio M6/Frame M6 screws (Torx 30) |
| 5 Perno Ø10/Ø10 pins | 14 Contropiastra telaio/Frame counterplate |
| 6 Grano M6x8/M6x8 grub screws | 15 Contropiastra anta/Sash counterplate |
| 7 Tappo cerniera/Hinge plugs | 16 Molle piastrino/Retaining springs |
| 8 Tappo asola/Buttonhole plug (2x) | 17 Distanziali profili telaio/Frame profiles Spacers |
| 9 Piastra rinforzo/Additional plate | |

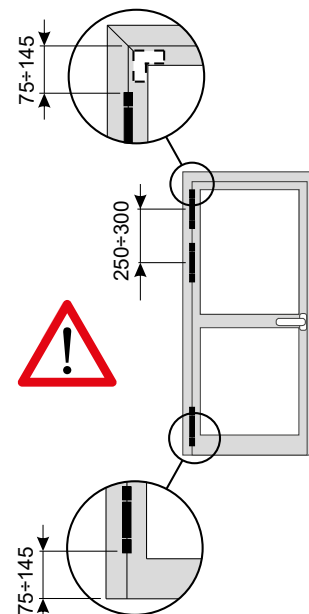

Info prodotto 2103

16.02.2021

ISTRUZIONI DI MONTAGGIO / REGOLAZIONI IN PRESSIONE

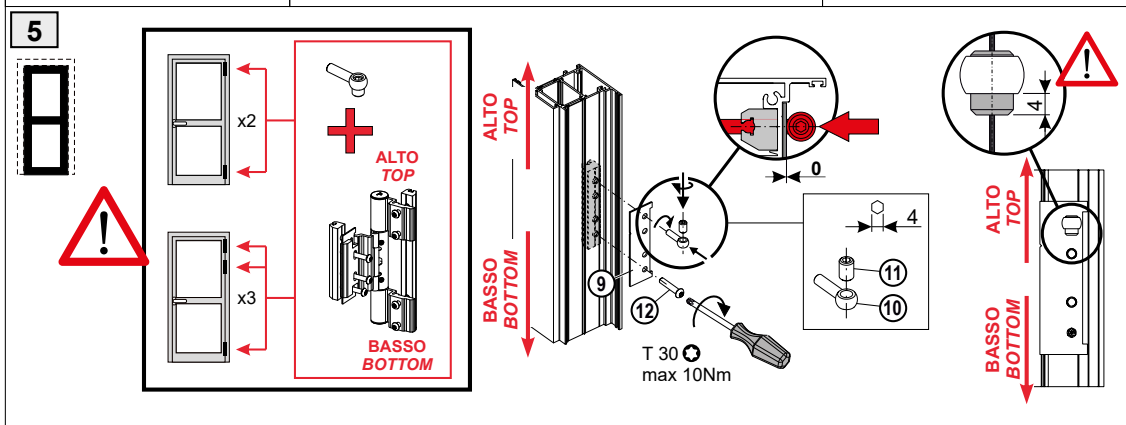
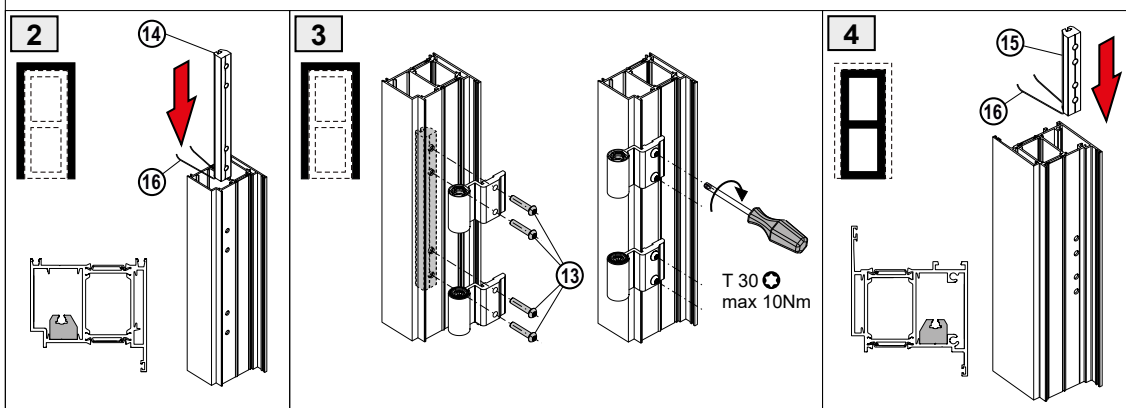
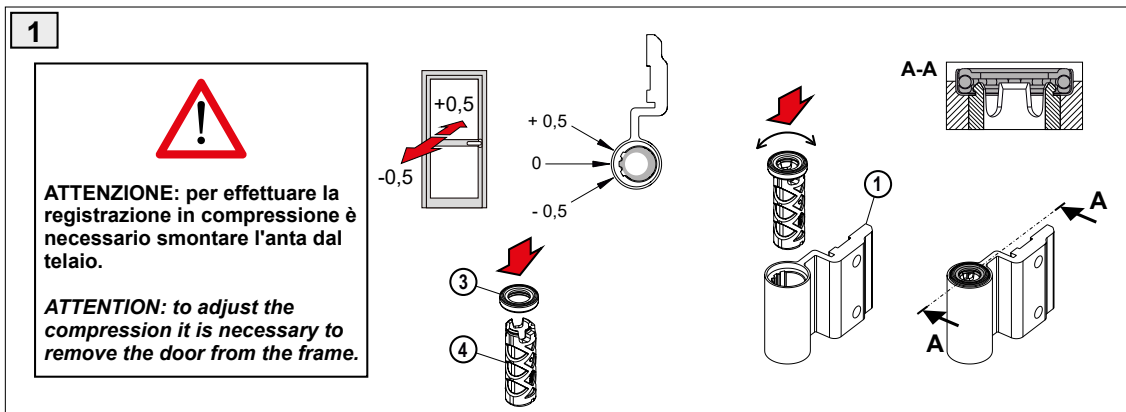
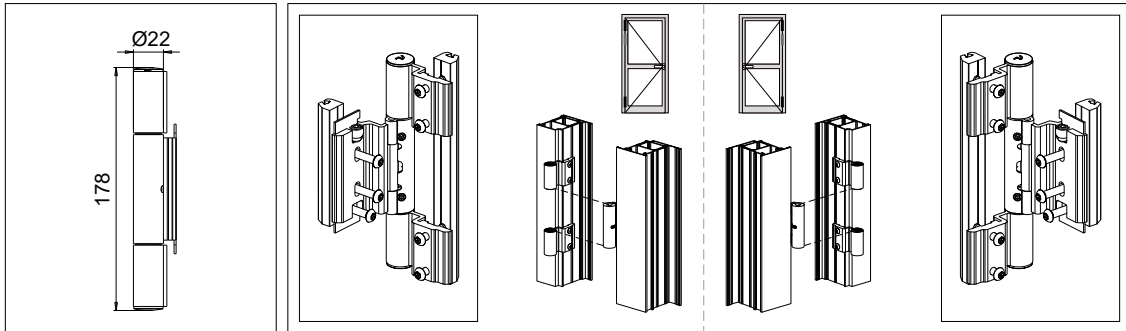

Info prodotto 2103

16.02.2021

ISTRUZIONI DI MONTAGGIO

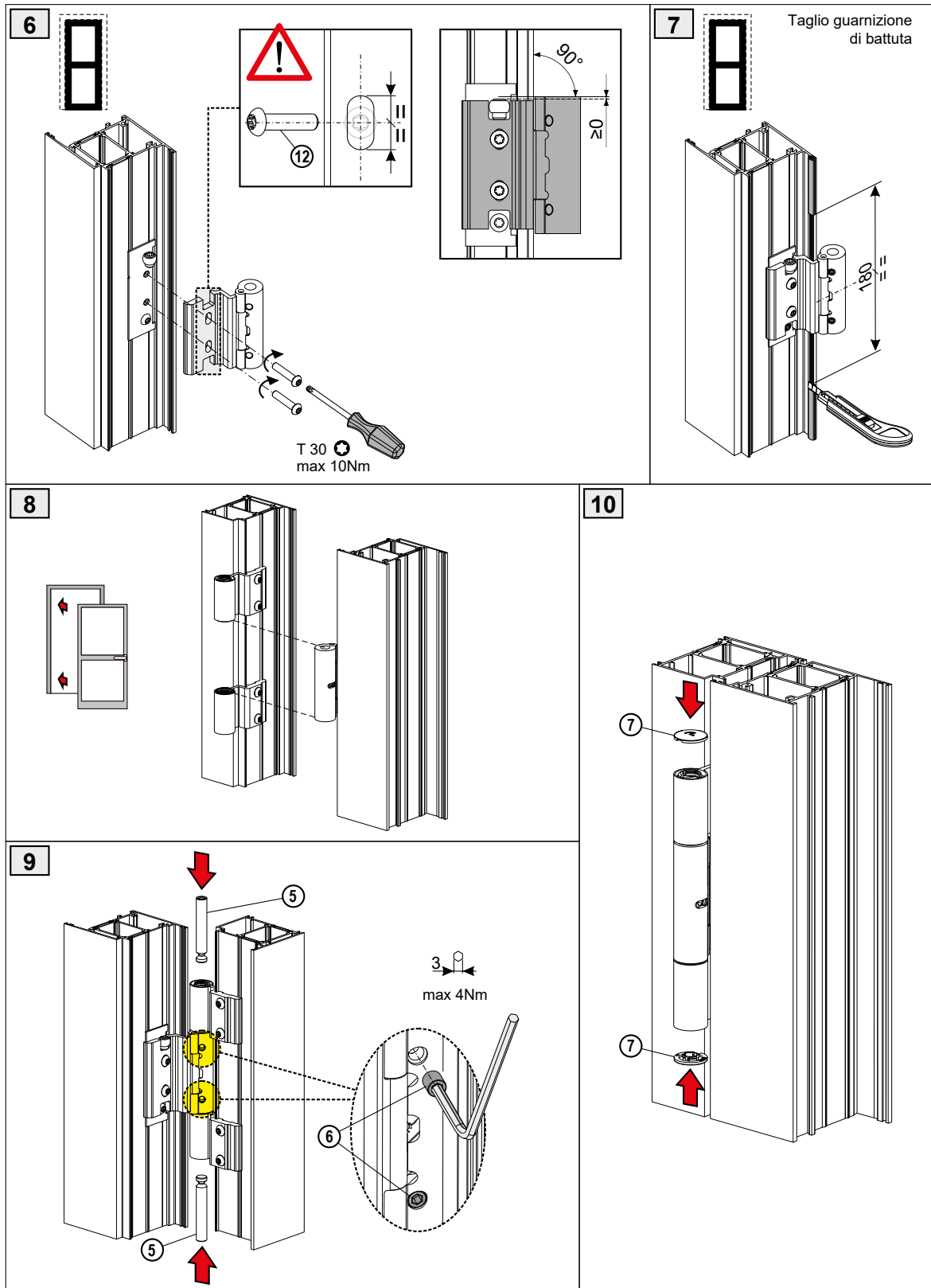

Info prodotto 2103

16.02.2021

ISTRUZIONI DI MONTAGGIO / REGOLAZIONI IN ALTEZZA

A

TUTTE LE CERNIERE DEVONO ESSERE REGOLATE ALLO STESSO MODO

ALL HINGES MUST BE SET THE SAME

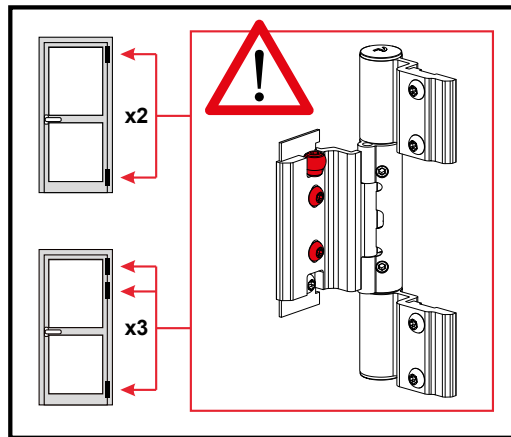
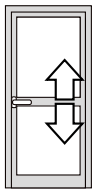

A.1

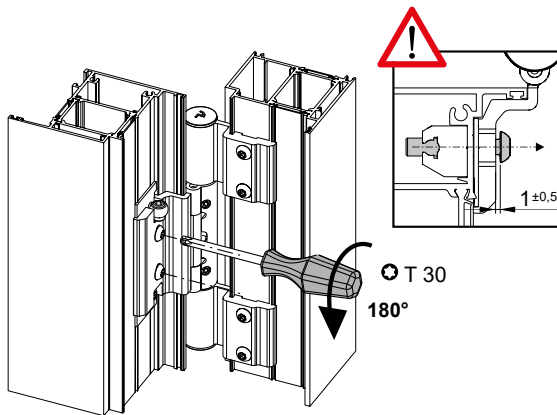

A.2

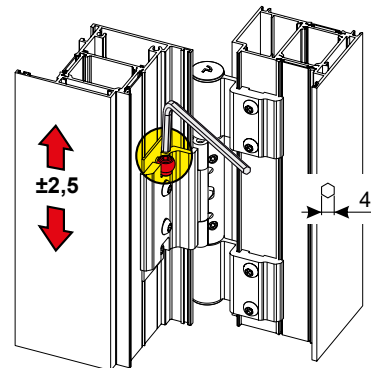

A.3

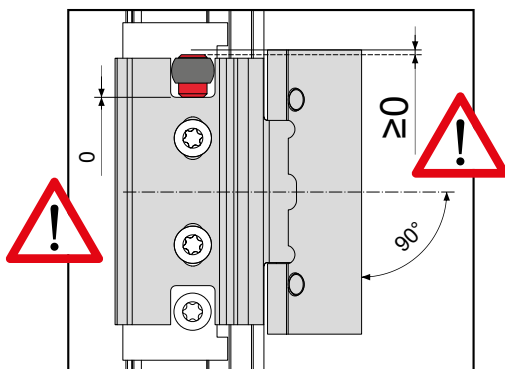

A.4

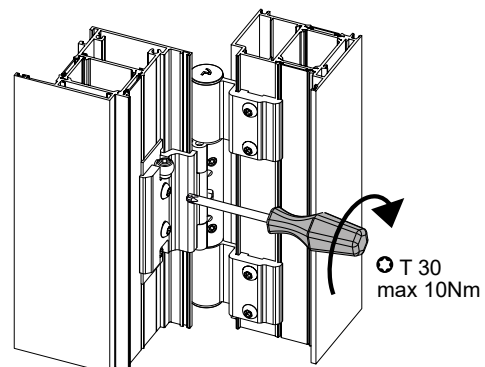

Info prodotto 2103

16.02.2021

ISTRUZIONI DI MONTAGGIO / REGOLAZIONE IN LARGHEZZA

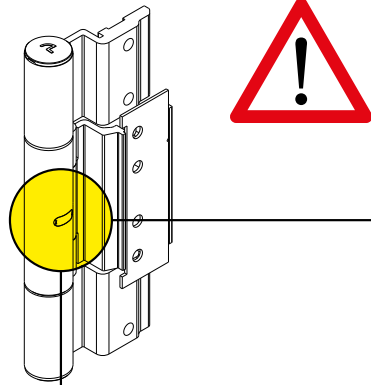

La cerniera viene fornita con il "grano di bloccaggio della regolazione laterale" (z) **serrato e bloccato**.

Prima di effettuare la regolazione laterale sul grano (y) (chiave esagonale 4 mm) è **assolutamente necessario** sbloccare il grano (z) con una chiave esagonale di 2 mm.

*The hinge is supplied with the "side adjustment locking grub screw" (z) **tightened and locked**.*

*Before making the side adjustment on the grub screw (y) (4 mm hex wrench) it is **absolutely necessary** to unlock the grub screw (z) with a 2 mm hexagonal wrench.*

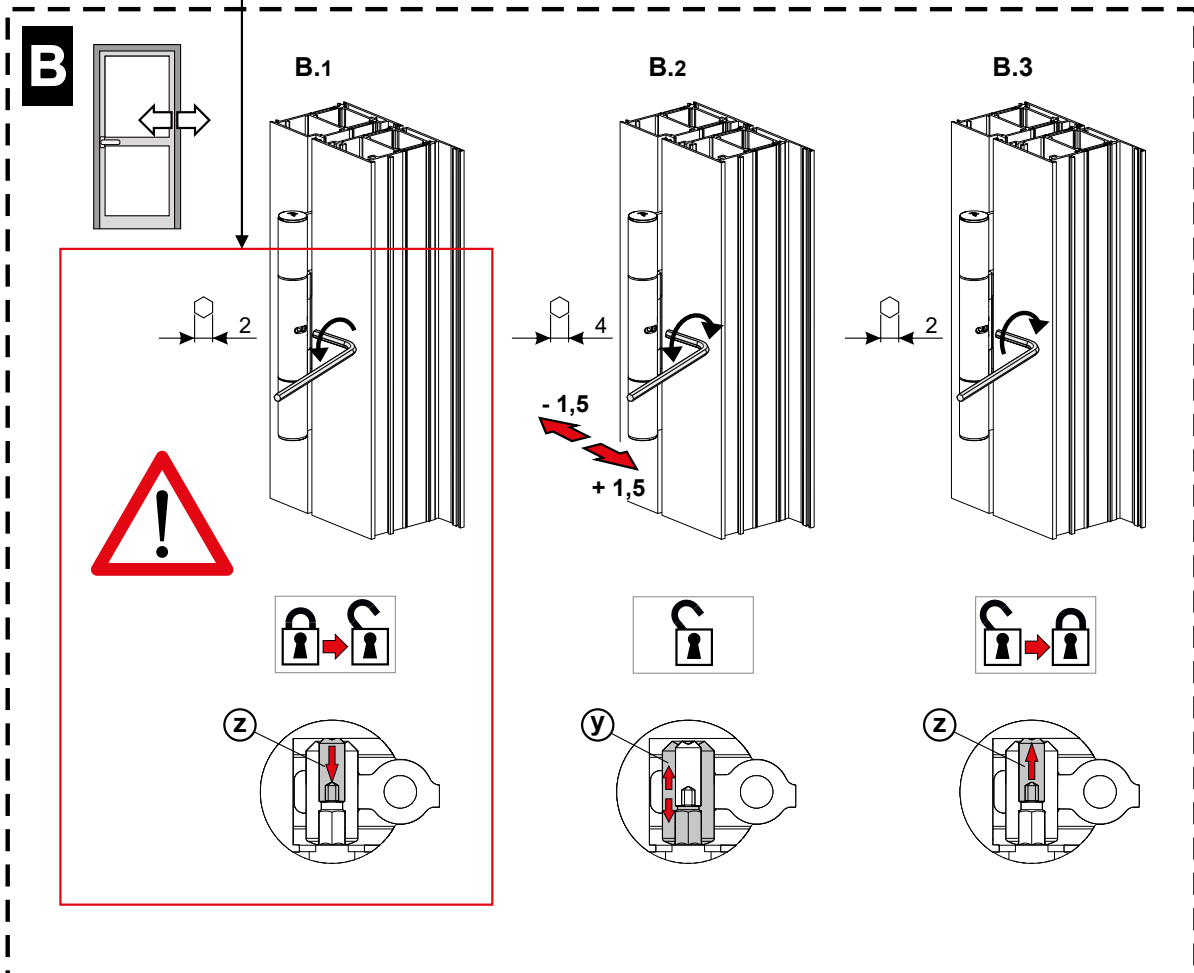

Info prodotto 2103

16.02.2021

ISTRUZIONI DI MONTAGGIO / REGOLAZIONI

