

PLANET 62 UP

Correzione

Si segnala che nel catalogo Planet 62 UP (Full Edition, **v1.0**) le pagg. 35-61-62 sono errate. Modificata immagine della barretta lato vetro.

Vi invitiamo a sostituirle con le pagine che vi allegiamo in questa comunicazione.









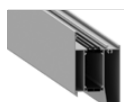
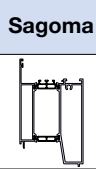
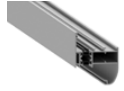
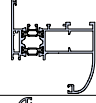

**ATTENZIONE: per verificare la versione del catalogo in vostro possesso controllare il numero di edizione riportato in corrispondenza del pedice di ogni pagina e sul retro di copertina accanto al QR-Code.*

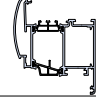
PLANET **62 UP**

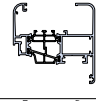
SISTEMA
PER SERRAMENTI

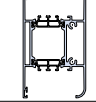

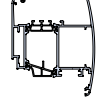
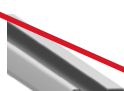
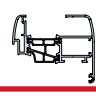
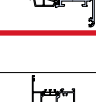
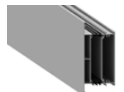
barretta lato
vetro

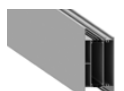
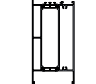
Sagoma	Art.	Descrizione	Peso gr/m	Jxx cm ⁴ Jyy cm ⁴
	 UP 61848	Zoccolo riportato per ante lisce da 70mm fissaggio a vite <i>fitted base for 70mm smooth leaves</i>	2310	51.15 84.50
	 UP 61849	Telaio a "Z" con battuta 25mm, spalla 42mm <i>"Z" frame with beat 25mm, wall 42mm</i>	1379	-
	 UP 61850 *	Anta bombata maggiorata <i>oversized convex leaf</i>	1968	48.85 37.78
	 UP 61851	Anta vetro infilare spazio spazio vetro 42mm <i>leaf base for beadless glass gap 42mm</i>	1540	38.10 15.10
	 UP 61853	Traverso vetro infilare 94mm spazio vetro 42mm fissaggio a vite <i>94mm transom</i>	1888	30.94 38.60
	 UP 61856 *	Anta vetro infilare bombata maggiorata spazio vetro 42mm <i>oversized convex leaf base for beadless glass gap 42mm</i>	1982	53.00 40.31
	 UP 61857	Anta vetro infilare Yard spazio vetro 42mm <i>Yard leaf base for beadless glass gap 42mm</i>	1381	30.84 8.67
	 UP 61860 *	Anta vetro infilare Yard spazio vetro 34mm <i>Yard leaf base for beadless glass gap 34mm</i>	1383	
	 UP 61858	Fascia da 165mm per ante lisce da 70mm. Fissaggio a vite <i>165mm band for 70mm smooth doors Screw fixing</i>	3302	74.93 241.63
	 UP 61859	Zoccolo da 165mm per ante lisce da 70mm. Fissaggio a vite <i>165mm plinth for 70mm smooth doors Screw fixing</i>	3303	75.41 241.74

*si consiglia di utilizzare controsagoma durante il taglio a 45° / it is advisable to use a counterprofile when cutting at 45°

PROFILI, ACCESSORI E GUARNIZIONI DI QUESTO CATALOGO SONO
DI PROPRIETÀ DI ALSISTEM, TITOLARE DI TUTTI I DIRITTI DI ESCLUSIVA

PLANET 62 UP v1.0
Aluminum casement system with thermal break

35

Segue pagine corrette da sostituire al vostro catalogo

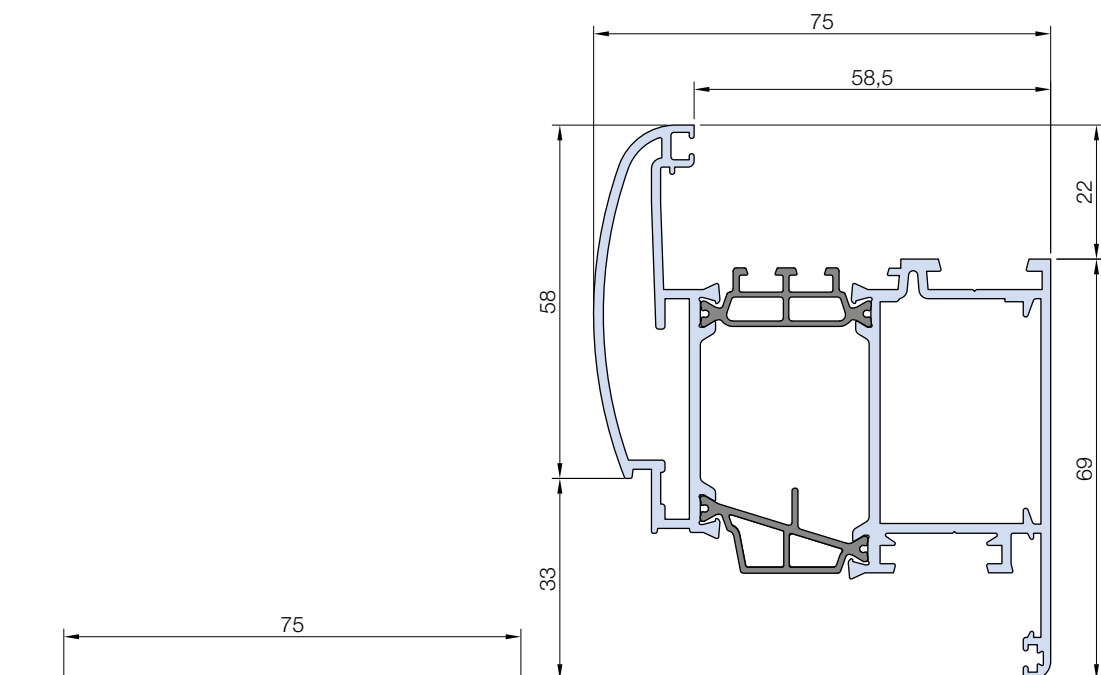

UP 61850

1968 g/m

SACOMARIO
Profilo rappresentativo

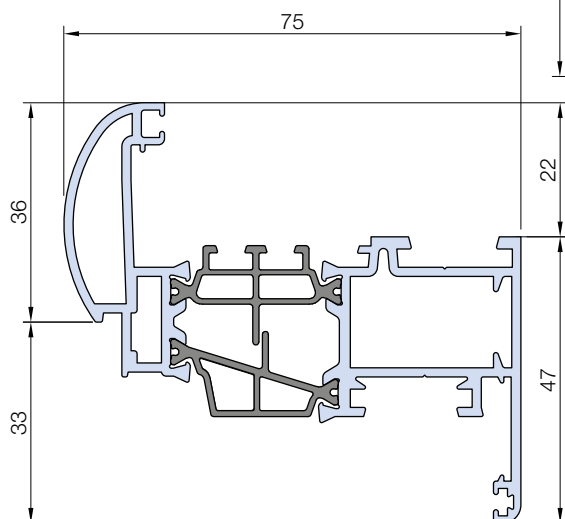

UP 61875

1504 g/m

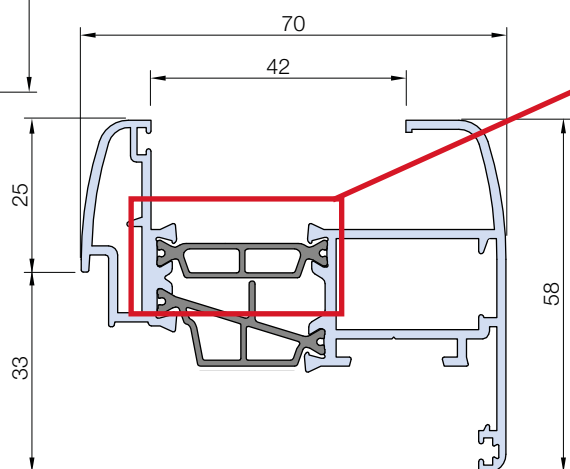

barretta lato
vetro

UP 61857

1381 g/m

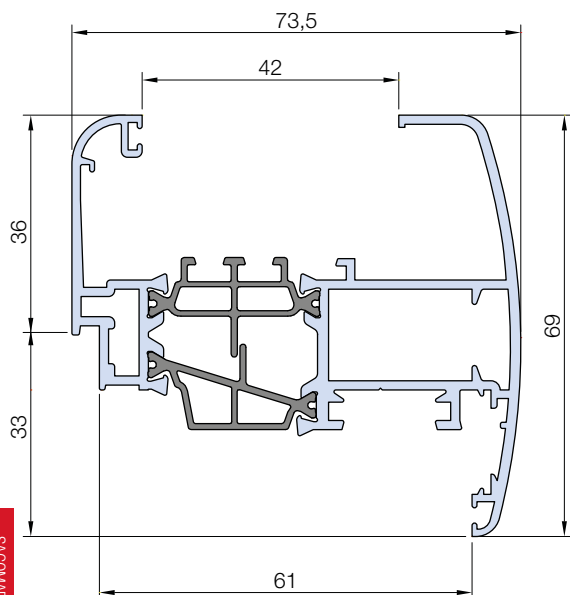

UP 62851

1577 g/m

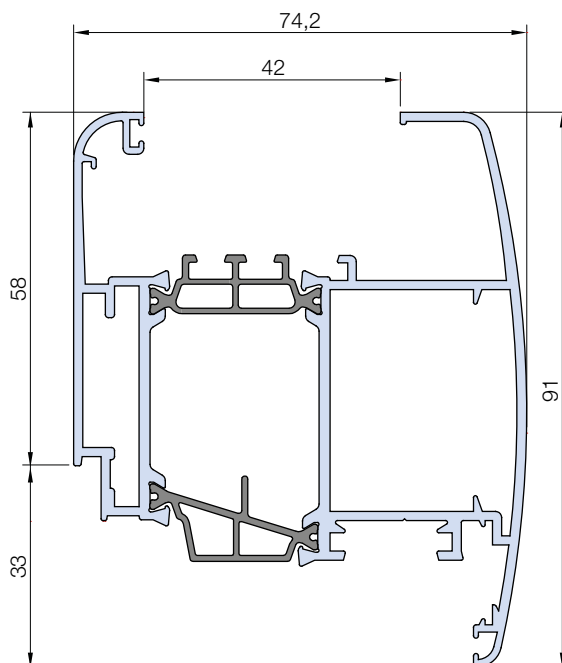

UP 61856

1982 g/m

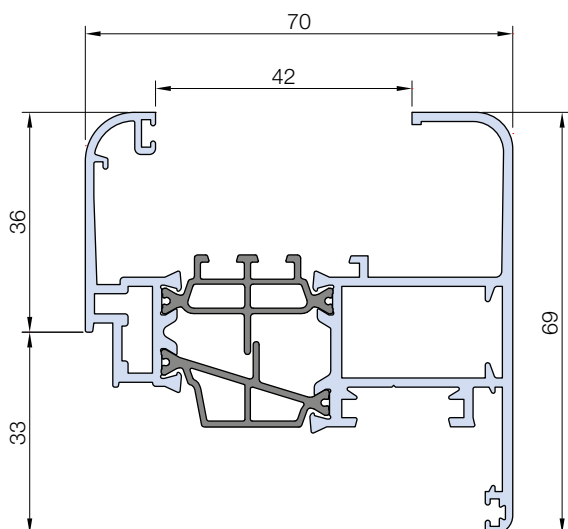

UP 61851



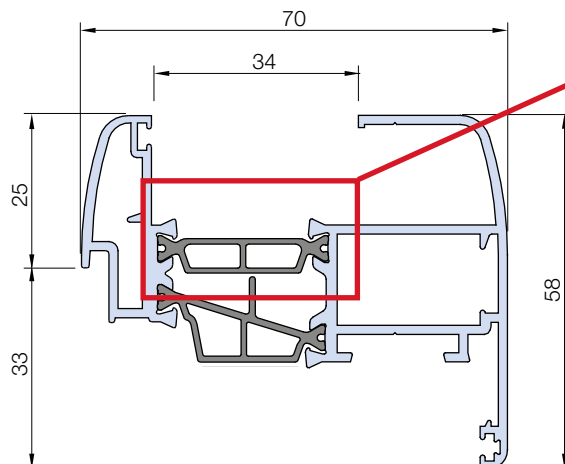





1540 g/m

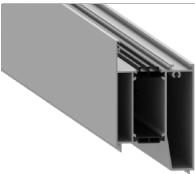
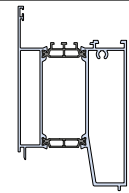
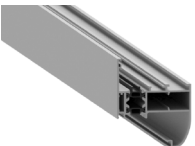
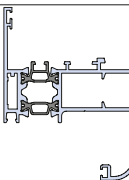

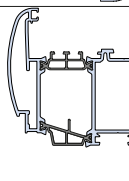
barretta lato
vetro

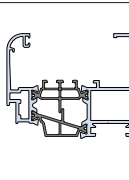
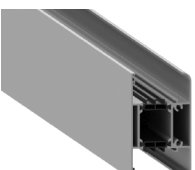
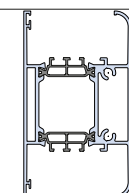
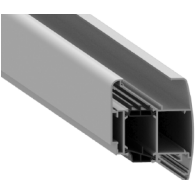
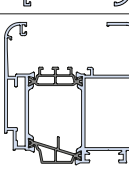
UP 61860

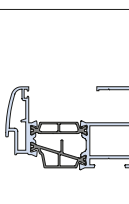
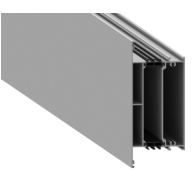
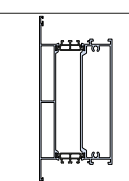
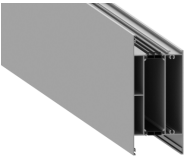
1383 g/m

	Sagoma	Art.	Descrizione	Peso gr/m	Jxx cm ⁴ Jyy cm ⁴
		UP 61848	Zoccolo riportato per ante lisce da 70mm fissaggio a vite <i>fitted base for 70mm smooth leaves</i>	2310	51.15 84.50
		UP 61849	Telaio a "Z" con battuta 25mm, spalla 42mm <i>"Z" frame with beat 25mm, wall 42mm</i>	1379	-
		UP 61850 *	Anta bombata maggiorata <i>oversized convex leaf</i>	1968	48.85 37.78
		UP 61851	Anta vetro infilare spazio spazio vetro 42mm <i>leaf base for beadless glass gap 42mm</i>	1540	38.10 15.10
		UP 61853	Traverso vetro infilare 94mm spazio vetro 42mm fissaggio a vite <i>94mm transom</i>	1888	30.94 38.60
		UP 61856 *	Anta vetro infilare bombata maggiorata spazio vetro 42mm <i>oversized convex leaf base for beadless glass gap 42mm</i>	1982	53.00 40.31
		UP 61857	Anta vetro infilare Yard spazio vetro 42mm <i>Yard leaf base for beadless glass gap 42mm</i>	1381	30.84 8.67
		UP 61860 *	Anta vetro infilare Yard spazio vetro 34mm <i>Yard leaf base for beadless glass gap 34mm</i>	1383	
		UP 61858	Fascia da 165mm per ante lisce da 70mm. Fissaggio a vite <i>165mm band for 70mm smooth doors. Screw fixing</i>	3302	74.93 241.63
		UP 61859	Zoccolo da 165mm per ante lisce da 70mm. Fissaggio a vite <i>165mm plinth for 70mm smooth doors. Screw fixing</i>	3303	75.41 241.74

*si consiglia di utilizzare controsagoma durante il taglio a 45° / *it is advisable to use a counterprofile when cutting at 45°*

ELENCO PROFILI
List of profiles

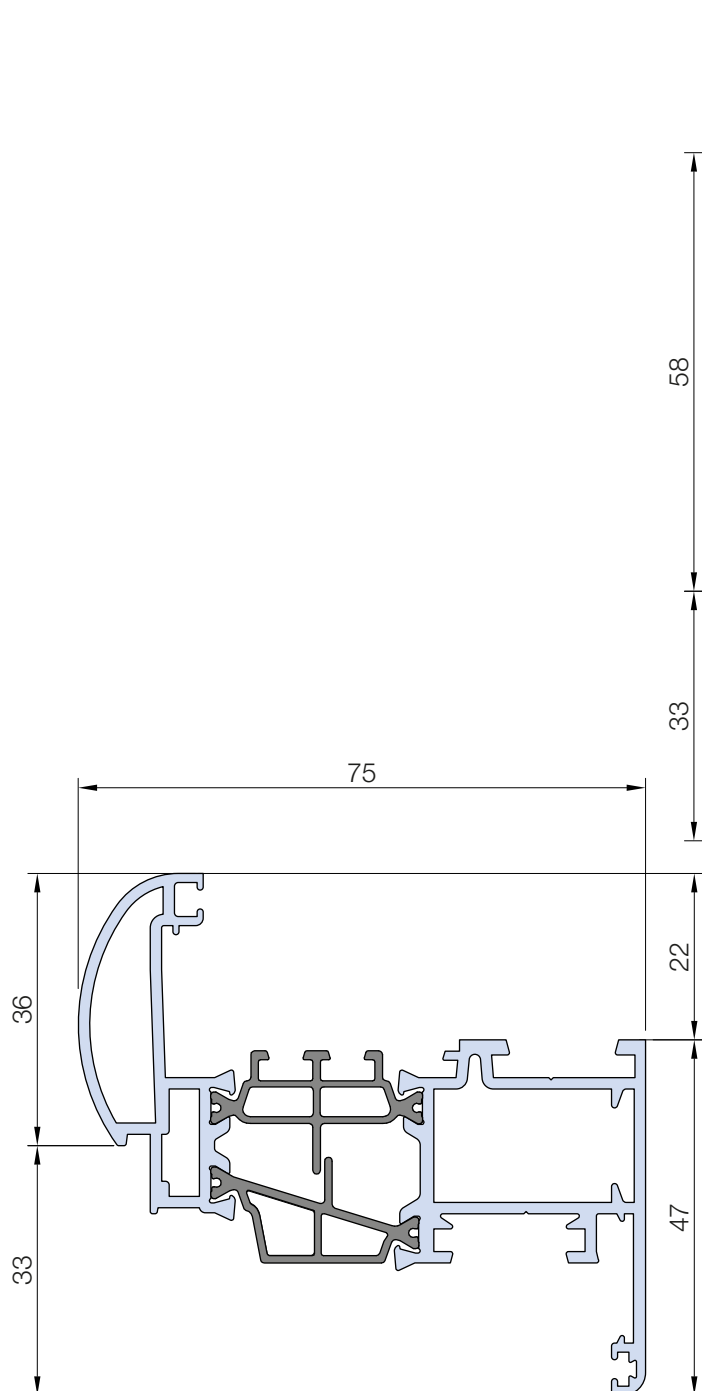

UP 61875

1504 g/m

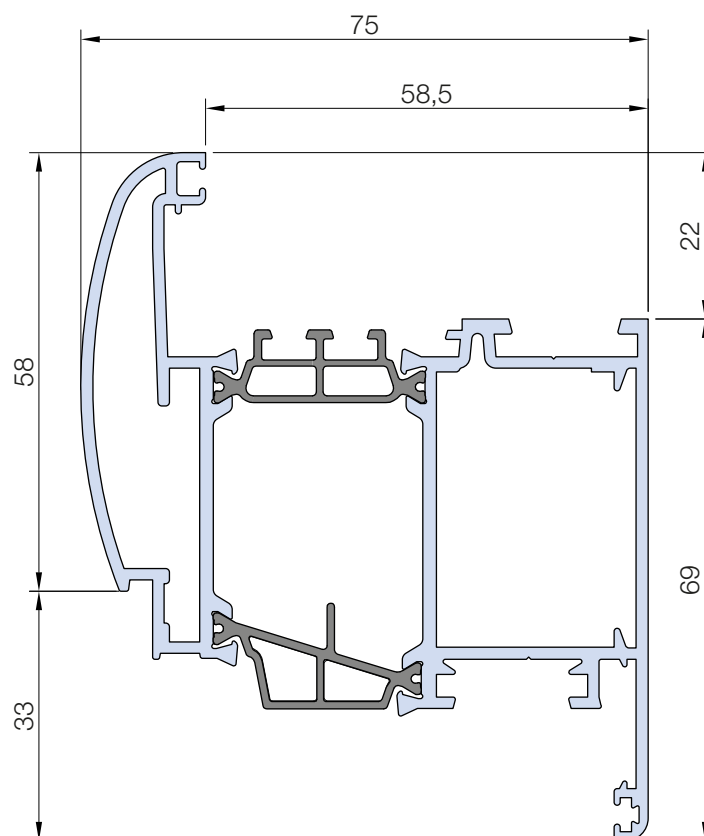

UP 61850

1968 g/m

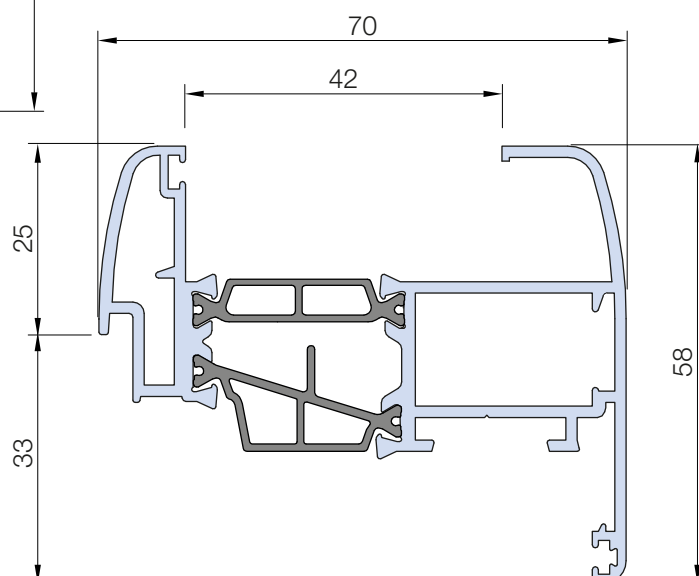

UP 61857

SAGOMARIO
Profile representation

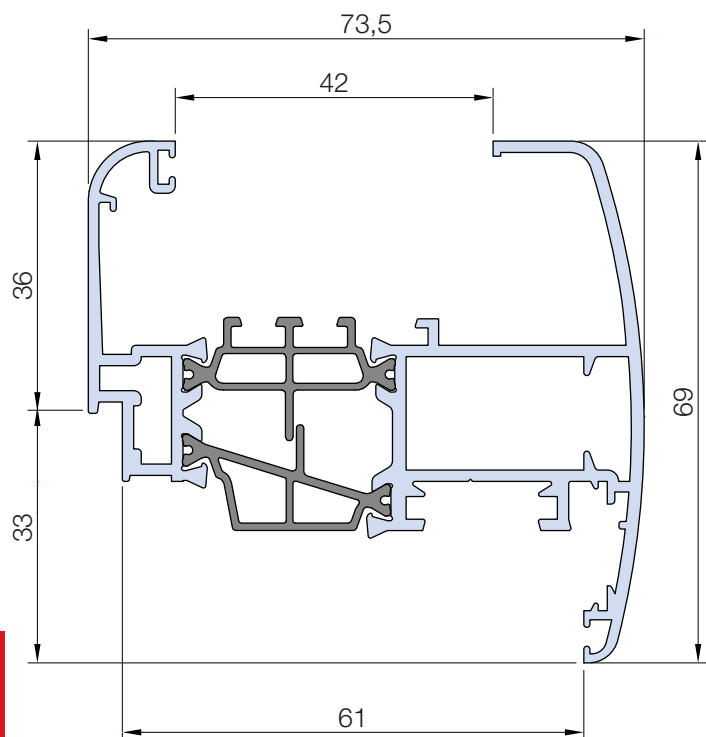
**UP 62851**

1577 g/m

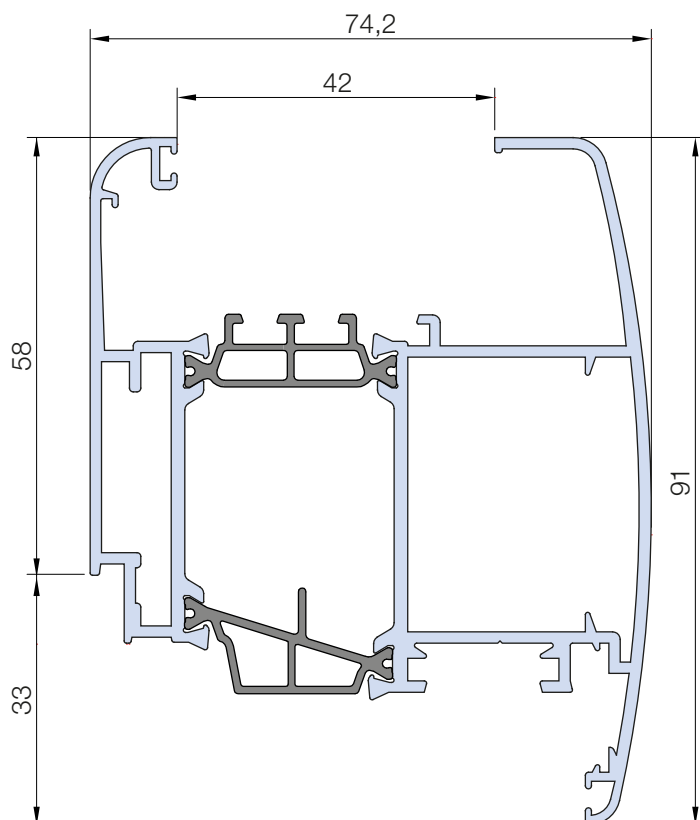
**UP 61856**

1982 g/m

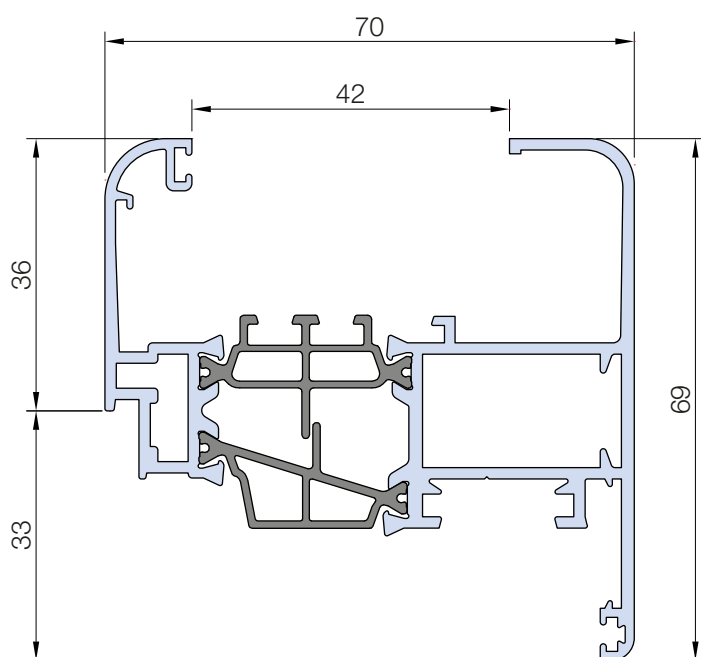
**UP 61851**

1540 g/m

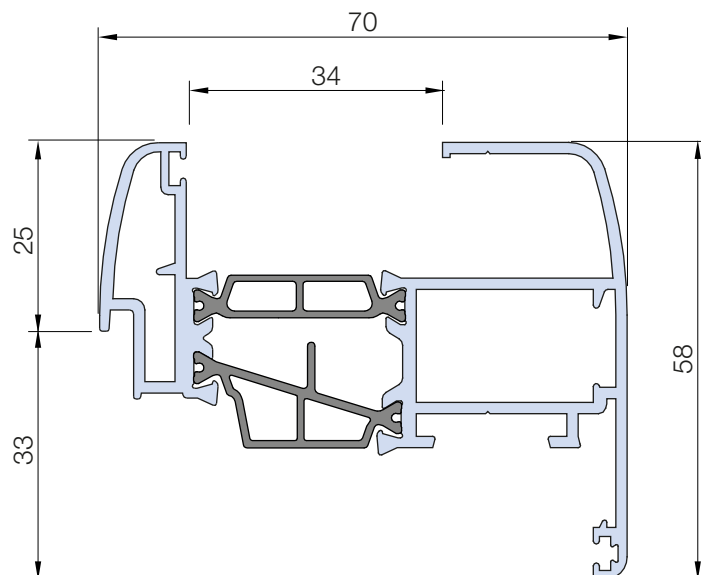
**UP 61860**

1383 g/m